

09

NOTES

- 1.This device is suitable for 2.4Ghz WIFI, not for 5G.
- 2.Please test the working distance between the receiver and the call button before installation to avoid missed alarms.
- 3.Please do not install the call button on a metal door, metal will interfere with the signal and affect the working distance.
- 4.Please do not install the receiver near electrical appliances with electromagnetic wave such as TV set, induction cooker and microwave oven.
5. Do not place the receiver and call button near water or fire, which may cause accidents.

10

After sales service

Service guarantees:

We offer 30 days no-excuses return and exchange service and lifetime after-sales service.

You can contact our after-sales team for any product problems:

aftersale-help@outlook.com

You can also contact us through Amazon email, we will provide you with satisfactory after-sales service.



MULTIFUNCTIONAL PAGER

Operation Instruction



01 QR Code for Operation Video	01
02 Appearance introduction	02~03
03 Pager Working Principle	04
04 Connect with Mobile APP	05~13
Download APP & Notes on distribution network	05
Connect the Receiver to APP	06~09
Connect the SOs Button to APP	10~11
APP Notification Settings	12
Cell Phone Notification Settings	13
05 APP Operation	14~17
Mutiple People sharing	14
Button Setting	15
Receiver settings	16
Unbind mobile APP	17
06 Installation	18~19
Receiver Installation	18
Button Battery Replacement	19
07 Specification & 08 Q&A	20~21
09 Notes & 10 After Sales Service	22

01 QR Code for Operation

Scan the QR code to view the manual in different languages



Manuale operativo italiano



Manuel d'utilisation en français



Deutsche Gebrauchsanweisung



Manual del operador en español

QR Code for Operation Video



English Operation Video



Deutsches Betriebsvideo

02 Appearance introduction

1.Receiver

(TY03 Not includes rechargeable battery)
TY06 Receiver(Includes rechargeable battery)

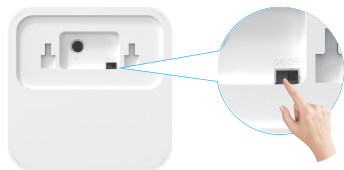

Turn on the power switch before performing all operations .

2.SOS Button



03 Pager Working Principle

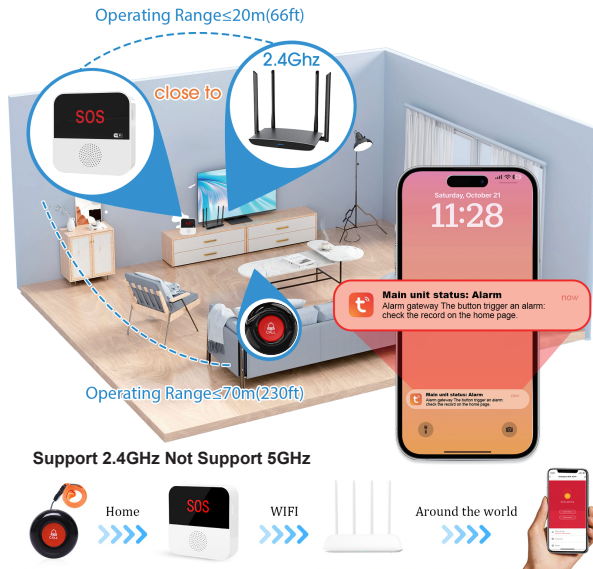

04 Connect with Mobile APP

1. Download APP



Tuya Smart



Smart Life

- Scan the QR code to download the APP.
- Please go to the application market to search for "Tuya Smart" or "Smart Life".

2. Notes on distribution network

Wi-Fi Frequency



Support 2.4GHz
Not Support 5GHz

3. Connect the Receiver to APP

 Both APPs are similar in use, just choose one of them

- ① Cell phone connected to Wifi(2.4GHz Wi-Fi), ② and turn on Bluetooth.

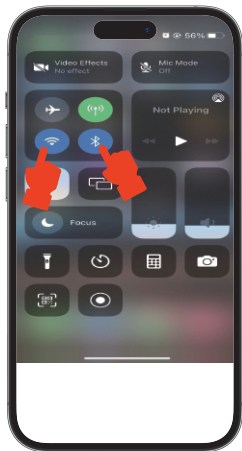

a Long press the key in the back of the Receiver for 6 seconds to enter distribution network.

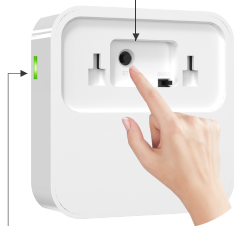

b The green light flashes continuously.

- ③ Open APP, click "Add Device".

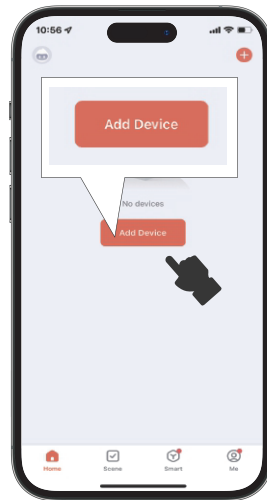

- ④ Click "Add" after the device is automatically discovered.

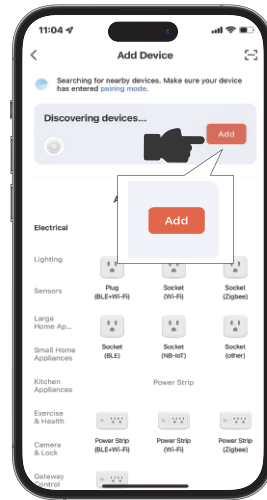

⑤ Confirm WiFi's name and password, and click "Next"

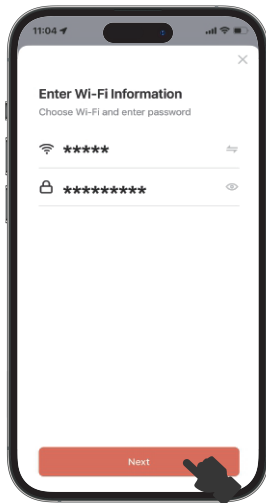

⑥ Wait for a successful connection.

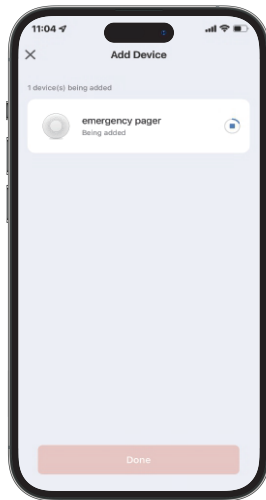

⑦ Click "Done".

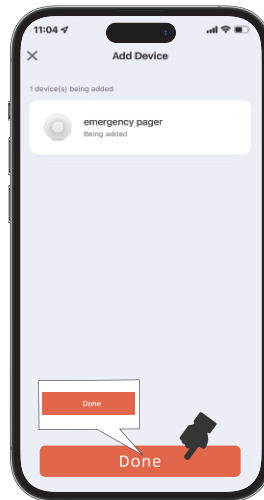

⑧ Receiver's page in the APP.

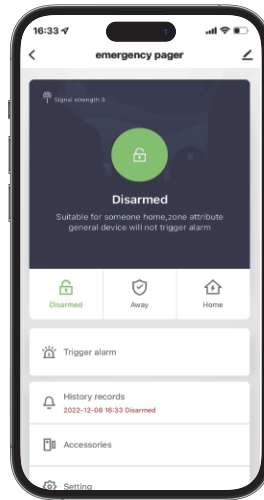

4. Connect the SOS Button to APP

- ① At the bottom of the Receiver's page in the APP, Click "Accessories".
- ② Click "+" in the upper right corner.

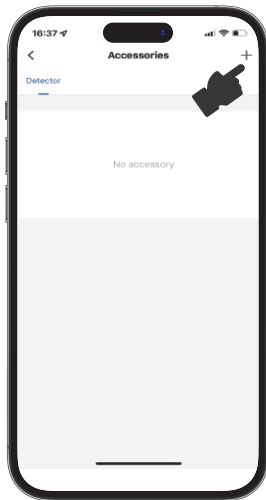
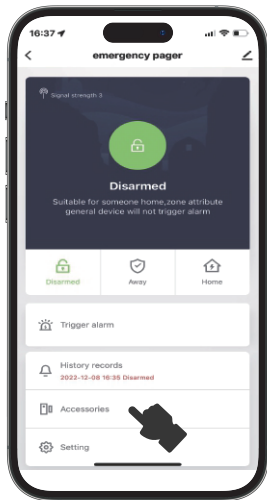

- ③ After the Receiver is "beep", please short press the SOS Button.
- ④ Wait for a successful connection, click "Confirm".

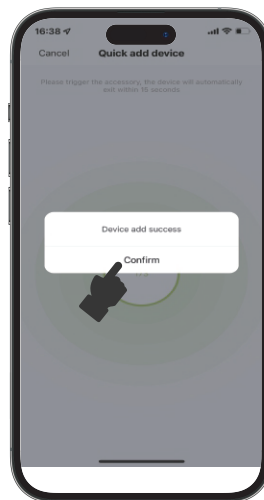
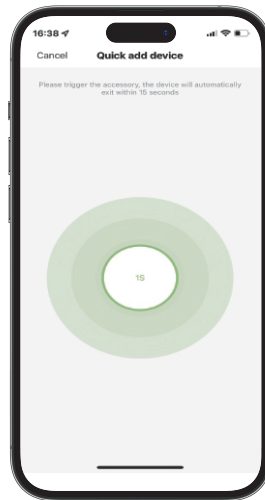

5.APP Notification Setting

- ① Click "Me", and click "Me" in the upper right corner

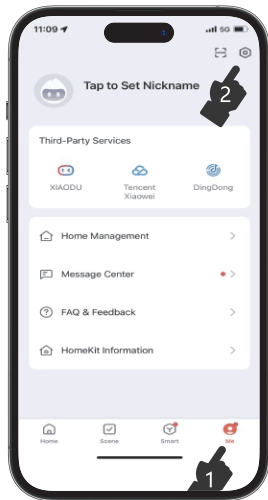

- ② Click "APP Notifications" → Open Notifications

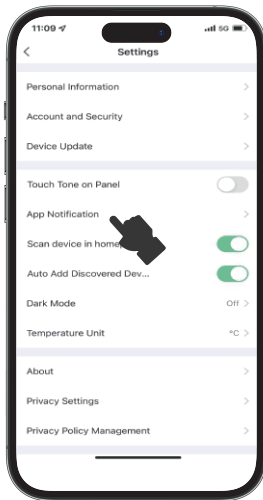

6.Cell Phone Notification Settings

- ③ Turn on Bluetooth and Local Network, and click "Notifications".

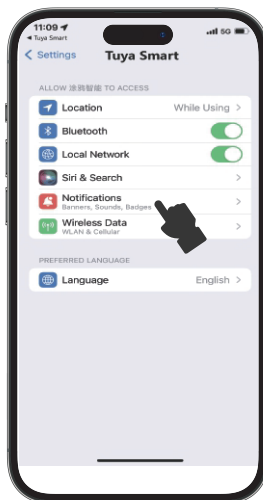

- ④ Turn on "Allow Notifications", "Sounds" and "Badges", and choose Alerts ways you like

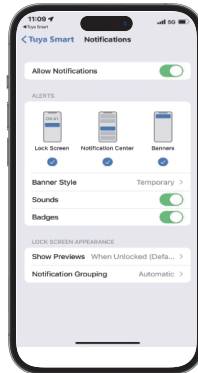

Please keep your cell phone in "Ringing Mode" to receive timely alert reminders.

This notification template is for Apple phones, for other types of phones, please find the notification and turn it on

05

APP Operation

1.Mutiple People Sharing

- ① Click "⌵" on the upper right corner of the Receiver's page in the APP.
- ② Click "Share Device"
Sharing is accomplished by adding a Tuya account or sharing to other software

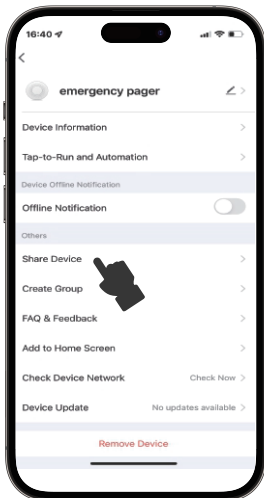
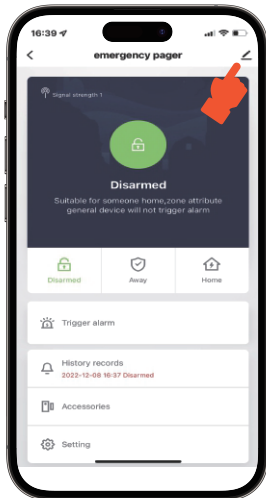

2.Button Setting

- ① At the bottom of the Receiver's page in the APP, Click "Accessories".
- ② Use this page to name the buttons and change the alarm ringtone and device type.

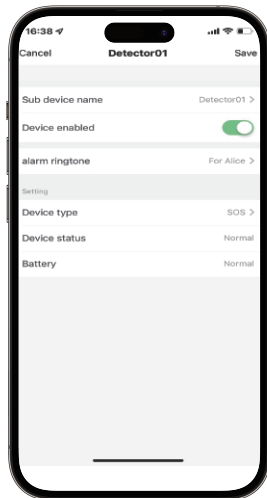
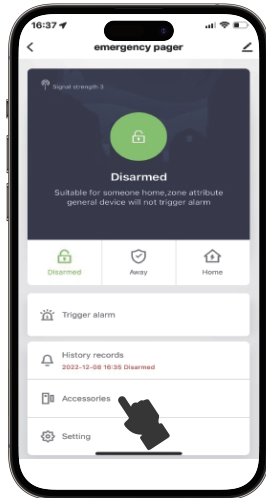

3.Receiver Setting

- ① At the bottom of the Receiver's page in the APP, Click "Setting".

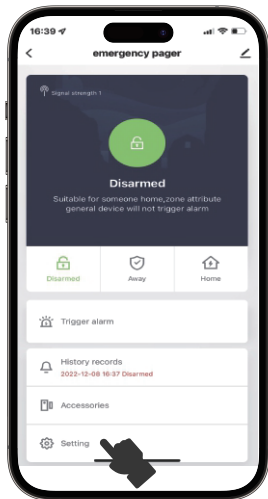

- ② change the alarm volume/alarm light brightless/alarm time/alarm delay

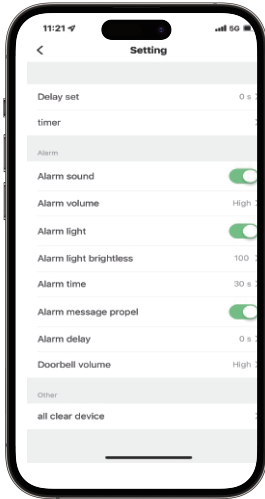

4.Unbind mobile APP

- ① Click "⌵" on the upper right corner of the Receiver's page in the APP.

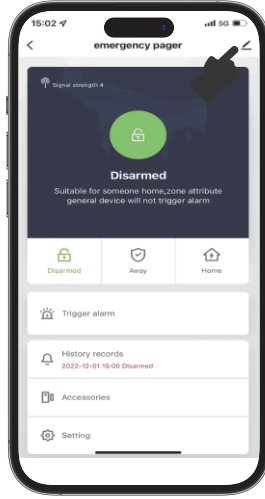

- ② Click "Remove Device".

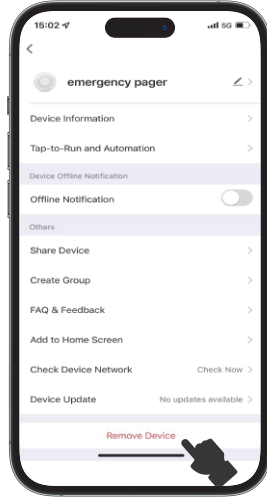

06 Installation

1.Receiver Installation

① Installation Distance



APP's Function can not be used if the Receiver was not connected with APP via WiFi.

② 2 ways to place



1. On the table

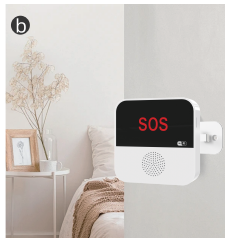

2. Wall mounting

2.Button Battery Replacement



STEP 1



STEP 2



STEP 3



STEP 4



STEP 1



STEP 2

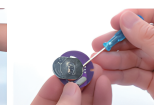

STEP 3



STEP 4



STEP 1



STEP 2



STEP 3

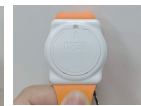

STEP 4



Use Times:6k-7k
Charging time:1.5H
Blue Light :low power alert
Red Light :charging
Green Light :full charged

07 Specification

Operating voltage: 5V	Static current: ≥60mA
Alarm current: ≤200mA	Wireless frequency: 433.92MHz
Wi-Fi: IEEE 802.11 b/g/n 2.4G	
Working temperature: -10°C~50°C	

08 Q&A

Q: What if the Receiver cannot enter the distribution mode?

A: Long press the Receiver's setup button, the Receiver's green light will not flash and it cannot enter the distribution network mode. At this time, please try to charge the Receiver before pairing.

Q: Does the Receiver need to plug in USB power cable all the time?

A: For the regular Receiver, the Receiver need to plug in USB power cable all the time. For the Receiver with rechargeable battery, it doesn't need to be plugged into a USB cable at all times when it's fully charged. Fully charge the receiver, it will still work well even if the power goes out in the house. You can find the remaining battery in the TUYA APP to decide whether to charge.

Q: What if the SOS Button cannot make the Receiver alarm?

- A:**
1. Please check the SOS Button to see if it has been paired with the Receiver successfully.
 2. Please check if the SOS Button is still powered (Press the SOS Button to see if it can light up.)
 3. Please make sure the SOS Button use within 230ft/70m range of the Receiver

Q: Can I take the SOS Button outside?

A: A: No, SOS Button need to be use within 230ft/70m range of the Receiver, and the Receiver need to be placed within 66ft/20m range of the Receiver (the closer the better).

Q: What if the Receiver cannot connect to smartphone?

- A:**
1. Check if you are using 2.4G network, if you are using 5G network, you can switch to 2.4G for pairing, and then switch to 5G network after pairing is complete.
 2. Make sure the distance between the receiver and the Wifi is within 66ft/20m.
 3. Check if your phone is connected to the wifi and if Bluetooth is turned on.
 4. Try to reboot the router.
 5. Try to uninstall and reinstall the tuya software.
 6. Check whether the network is stable or not, unstable network will affect the addition of devices.